

INSPECTION REPORT

GENERAL DESCRIPTION

Product Description .: Smartwatch with bluetooth conection and app notification.	
	Report number .:
	Inspection Date.:
	Service Item .:
	<input type="checkbox"/> PSI <input type="checkbox"/> IPI <input type="checkbox"/> DPI <input type="checkbox"/> PM <input type="checkbox"/> FI <input checked="" type="checkbox"/> RE-PSI
	Customer .:
	Customer P.O .: 1780
	Vendor .:
	Vendor P.O No .:
	Target Market .:
	Manufacturer .:
Location Area .: Shenzhen,Guandong,China	

QUANTITY CHECK

Client P.O. #	Item No	Quantity on PO #		Actual Finished Quantity	
		Product Quantity	Cartons Quantity	Finished Quantity	Packed Cartons
1780	77161 (Black color)	700	12	700	12
	77161 (Silver color)	300	5	300	5
Total		1000	17	1000	17

INSPECTION INFORMATION

Inspection based on					
<input type="checkbox"/> Approval Sample	<input type="checkbox"/> Specifications	<input type="checkbox"/> P/O#	<input type="checkbox"/> Photos	<input type="checkbox"/> Drawing	<input checked="" type="checkbox"/> Others.:

OVERALL INSPECTION RESULT	FAIL
Bases On Below AQL & Approved sample& Remark:	
Approved sample	<input type="checkbox"/> Yes <input checked="" type="checkbox"/> No
AQL	FAIL Beyond AQL
Remark	FAIL Due to Remark 1 to 5

PROBLEMATIC REMARKS

1. Checked 125pcs, found 8pcs screen quality problem (6pcs skew screen, 1pc with the bottom of the screen turns blue,1pc screen scratched),which all mentioned at AQL table.
2. The factory said that this watch was not waterproof, so refused to do waterproof test.
3. The waterproof information printed on watch back cover is IP54, but on instruction and color box are IP65.
4. As 1 piece the screen broken,the factory agreed to open it for inspector to check the internal structure of the product.Then the insptor found capacity information on battery was 300mAh, but the one showed on instruction and color box were 320mAh.
5. For black design: The blue protective film protection was attached to the strap buckle and there was also a transparent protective film on the surface of the left strap. But no protective film for silver watch.
6. There were 3 different printing colors of the information and logo on watch back cover.Due to the light,some looked not very clear in the photos,but actually all the contents were same.
7. The factory refused to do all drop tests.

Notice: This report is issued by the company under its General Conditions for inspection, assessment, technical assistance. The issuance of this report does not exonerate buyers or sellers from exercising all their rights and discharging all their liabilities under the contract of sales. Stipulations to the contrary are not binding on the company. The company's responsibility under this report is limited to proven negligence and will in no case be more than eight times the amount of the fees or commission, which will be paid by free Man-day.

8. The factory could not provide the equipment to do battery capacity.
9. For the battery charge test, as the products all had basic electricity, the inspector could not check the full charge time, only checked the function of charge.
10. There was no condition to check the sleep monitoring function at the inspection site.
11. The inspector checked the basic function of heart rate, found all met the basic usage. But the factory could not prove the accuracy of them. We suggest adding a warning: "Once your body feels uncomfortable, please go to hospital in time."
12. Found the system languages were English, France, Spanish, Polski, Portuguese, Italian, Germany, Dutch, Turkic, Russia and Chinese. The default language was English.
13. As the manual was in Spanish, the functions and points for attention of the product could not be completely checked during the inspection.
14. 2pcs out of 125pcs, the speaker was found noisy, the inspector took videos when turning on to record the noise, but it was not very obviously to listen it in the video, which the factory has admitted the defects during the inspection and signed on the draft report.
15. Due to test condition and time limited, inspector checked 32pcs for heart rate test, all pass.
16. The factory updated the software, the notifications and messages could be synchronized by smartwatch during the inspection.

Please see below attached photos to demonstrate the above Problematic Remarks:

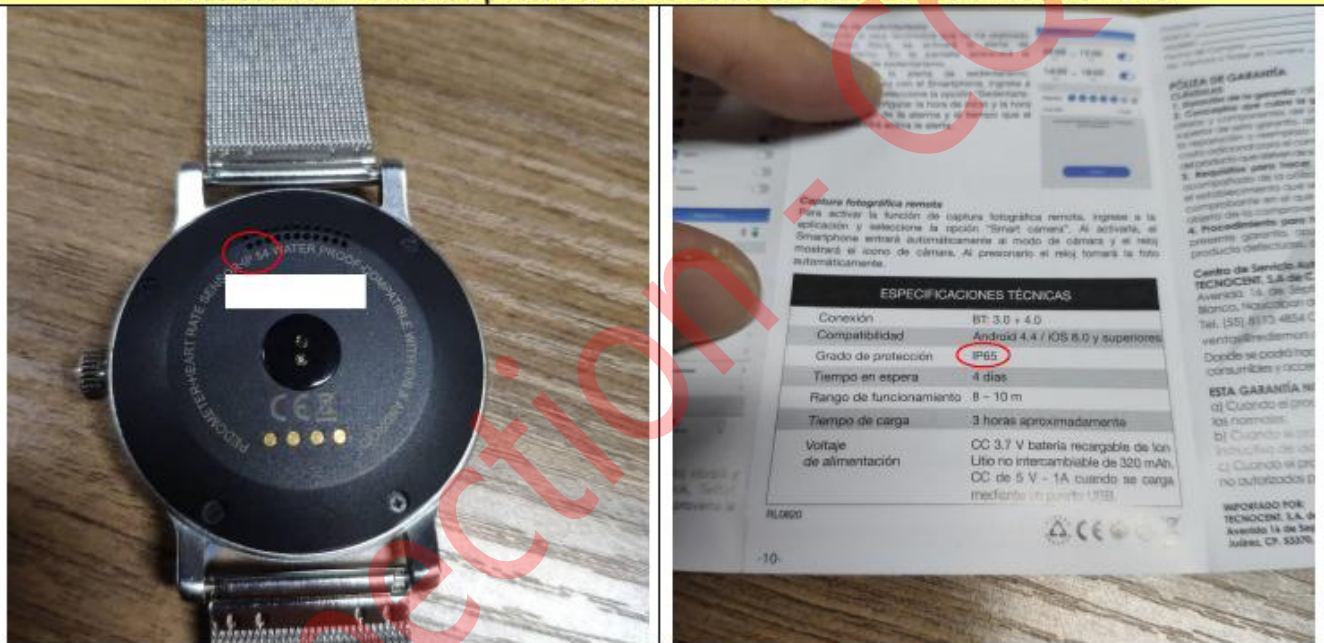

Remark 3: The waterproof information printed on watch back cover is IP54, but on instruction and color box are IP65.

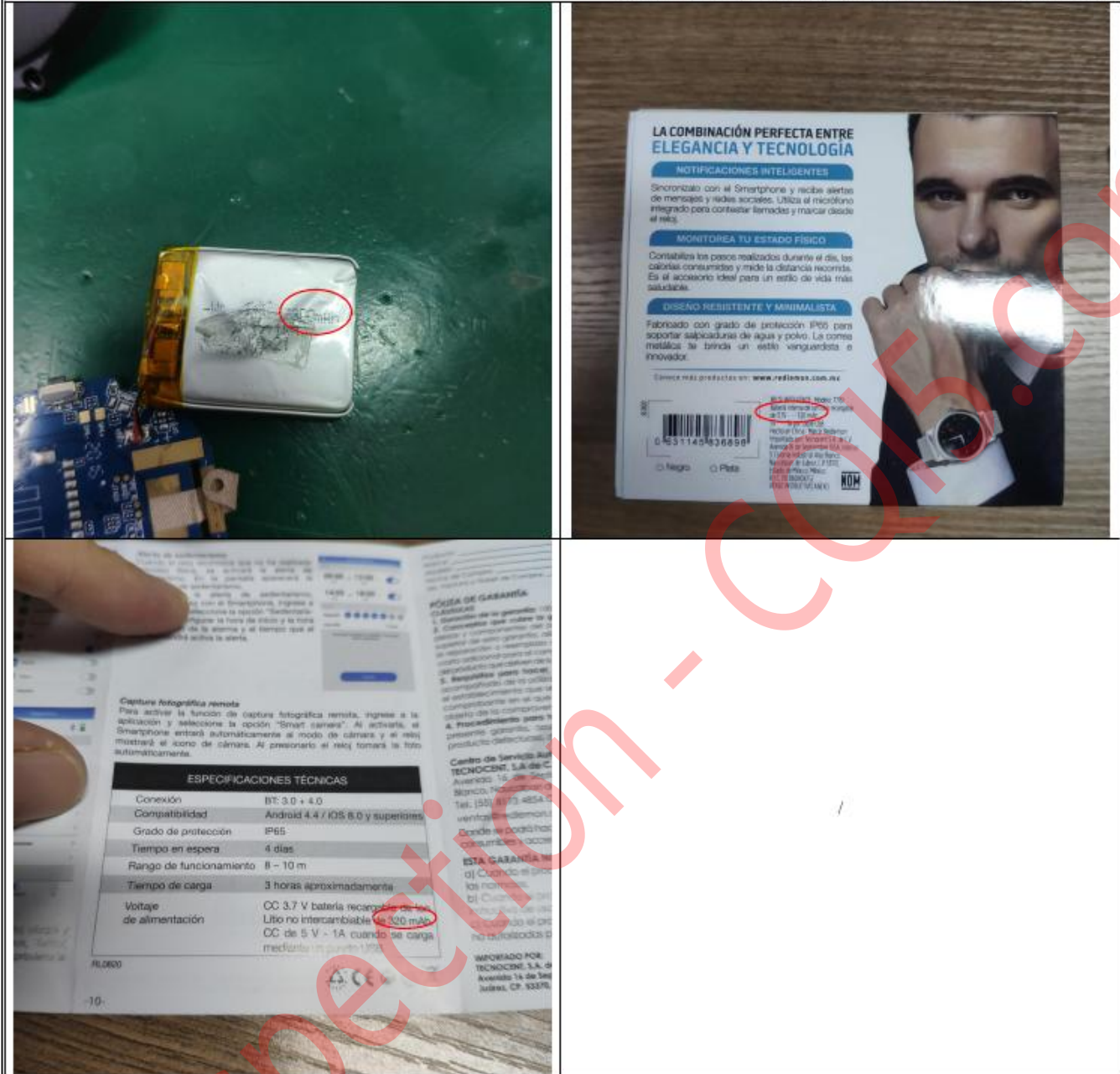

Remark 4:As 1 piece the screen broken,the factory agreed to open it for inspector to check the internal structure of the product.Then the insptor found capacity information on battery was 300mAh, but the one showed on instruction and color box were 320mAh.



Remark 5:For black design:The blue protective film protection was attached to the strap buckle and there was also a transparent protective film on the surface of the left strap.But no protective film for silver watch.



Remark 6: There were 3 different printing colors of the information and logo on watch back cover.Due to the light,some looked not very clear in the photos,but actually all the contents were same.

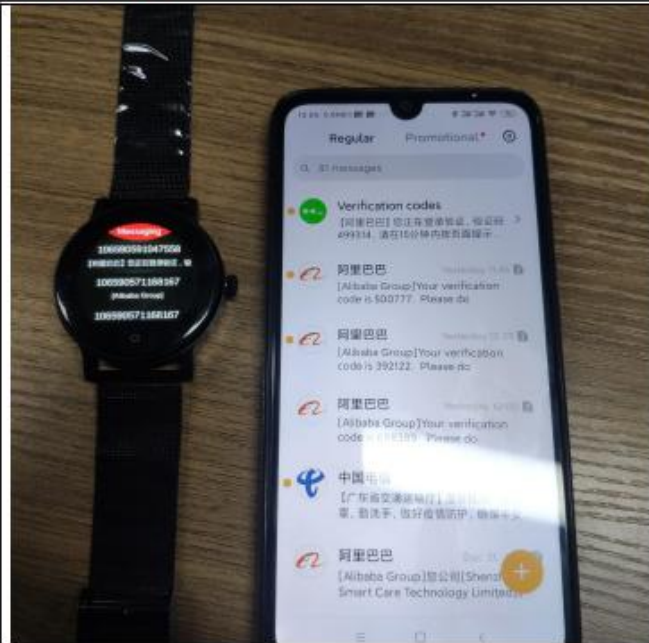

synchronize the messages of the phone



synchronize the messages of the phone



synchronize the notifications



synchronize the notifications

Remark 15: The factory updated the software, the notifications and messages could be synchronized by smartwatch during the inspection.

INSPECTION METHODS APPLIED

Inspection Criteria - Acceptable Quality Level (AQL)			
Inspection service requirement	Final Random Inspection		
Sampling standard performed per	ANSI/ASQC Z1.4-1993 Single sampling plan for normal inspection (ISO 2859-1, MIL-STD 105E, or BS6001)		
General inspection levels at	III	No. of sample size inspected	125PCS
Acceptable Quality Level (AQL) for :	Critical	Major	Minor
	Not allowed	2.5	4.0
No. of sample size inspected for :	125PCS	125PCS	125PCS
Total No. of packed cartons	17	cartons	Number of cartons open shall be the square root of the available cartons quantity.
No. of inspected cartons	4	cartons	
Samples selected from the following cartons :			
Comments.:	Item No.: 2,5,11,14		

Notice : This report is issued by the company under its General Conditions for inspection, assessment, technical assistance. The issuance of this report does not exonerate buyers or sellers from exercising all their rights and discharging all their liabilities under the contract of sales. Stipulations to the contrary are not binding on the company. The company's responsibility under this report is limited to proven negligence and will in no case be more than eight times the amount of the fees or commission, which will be paid by free Man-day.

APPEARANCE & FUNCTION INSPECTION

PO #		1780	Item No #		SKU 77161
No.	Details of Non-Conformity		Critical	Major	Minor
Appearance & Visual Defects					
1.	Scratch mark on the screen		0	1	0
Functional Defects					
2.	Skew screen		0	6	0
3.	The bottom of the screen turns blue		0	1	0
4.	Speaker is noisy-please refer to videos		0	2	0
Safety of product (Zero tolerance,if product hurts the users directly or potentially.)					
5.	/		0	0	0
Total defects found:			0	10	0
Maximum Critical/Major/Minor Allowed:			0	7	10
Samples Checked:			125	125	125
Inspection Result:			<input checked="" type="checkbox"/> Beyond AQL		

Defect Photo :



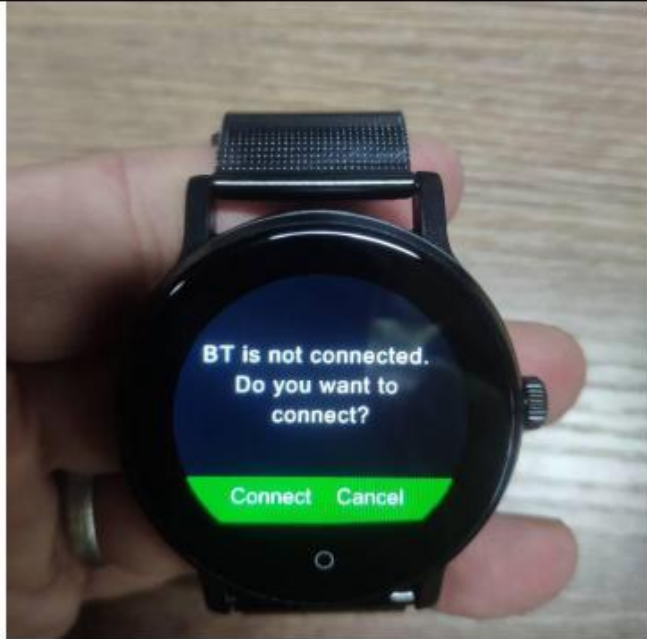

skew screen-major

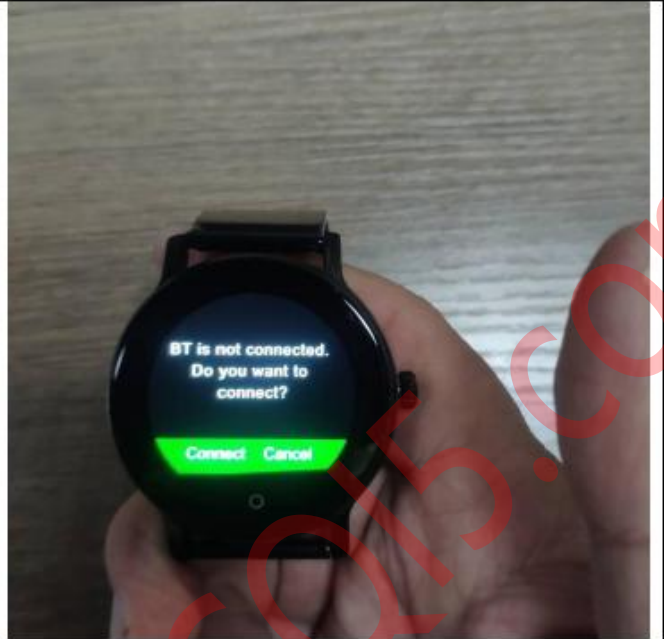

skew screen-major



skew screen-major

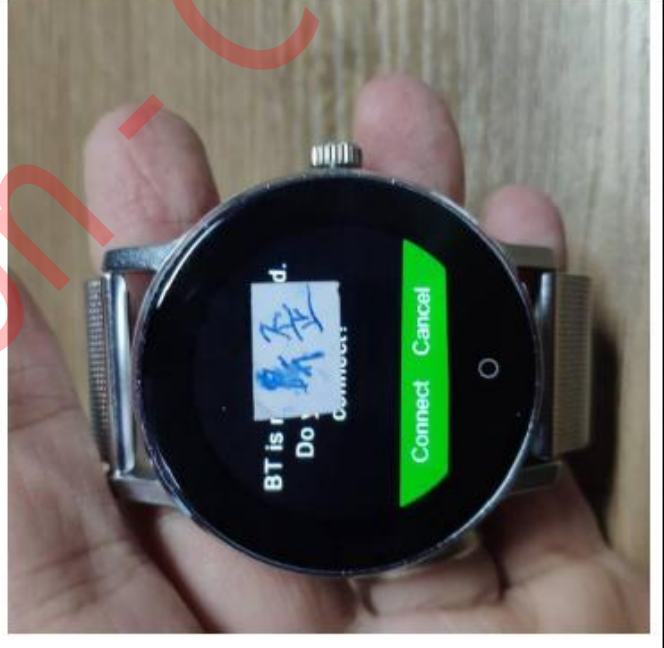

skew screen-major



GENERAL INSPECTION CHECKLIST

#	Inspection Item	Result			Testing Conditions & Requirements / Record	Sample Size
		Pass	Fail	Pend		
1.	Outside Appearance	<input type="checkbox"/>	<input checked="" type="checkbox"/>	N/A	Refer to defects on AQLs.	125pcs
2.	General Function Inspection	<input checked="" type="checkbox"/>	<input type="checkbox"/>	N/A	Refer to defects on AQLs.	125pcs
3.	Product Bare drop	<input type="checkbox"/>	<input type="checkbox"/>	<input checked="" type="checkbox"/>	Factory refuse to do these test	N/A
4.	Carton Drop test	<input type="checkbox"/>	<input type="checkbox"/>	<input checked="" type="checkbox"/>		N/A
5.	Barcode Scanning test	<input checked="" type="checkbox"/>	<input type="checkbox"/>	<input type="checkbox"/>	It could be read and correct.	5pcs
6.	Internal check	<input type="checkbox"/>	<input type="checkbox"/>	<input checked="" type="checkbox"/>	The capacity information on battery is 300mAh, But on instruction and color box are 320mAh;	1pcs
7.	On/off function test	<input checked="" type="checkbox"/>	<input type="checkbox"/>	<input type="checkbox"/>	Meet basic usage.	125pcs
8.	QR code scan test - Download the application (iOS and Android)	<input checked="" type="checkbox"/>	<input type="checkbox"/>	<input type="checkbox"/>	Meet basic usage.	5pcs
9.	Bluetooth connection test	<input checked="" type="checkbox"/>	<input type="checkbox"/>	<input type="checkbox"/>	Meet basic usage , but can not show the Bluetooth version	8pcs
10.	Bluetooth connection test at a distance of 10 meters	<input checked="" type="checkbox"/>	<input type="checkbox"/>	<input type="checkbox"/>	Meet basic usage.	8pcs
11.	Heart rate function check	<input checked="" type="checkbox"/>	<input type="checkbox"/>	<input type="checkbox"/>	Meet basic usage.	32pcs
12.	System language setting	<input checked="" type="checkbox"/>	<input type="checkbox"/>	<input type="checkbox"/>	Found the system languages were English ,France,Spanish,Polksi,Portuguese,Italian,Germany,Dutch,Turkic,Russia and Chinese.The default language was English.	5pcs
13.	Call function check	<input checked="" type="checkbox"/>	<input type="checkbox"/>	<input type="checkbox"/>	Meet basic usage.	5pcs
14.	Message reminder function check	<input checked="" type="checkbox"/>	<input type="checkbox"/>	<input type="checkbox"/>	Meet basic usage.	5pcs
15.	3M Adhesive test	<input checked="" type="checkbox"/>	<input type="checkbox"/>	<input type="checkbox"/>	Meet basic usage.	5pcs
16.	Call logs	<input checked="" type="checkbox"/>	<input type="checkbox"/>	<input type="checkbox"/>	Meet basic usage.	5pcs

Notice: This report is issued by the company under its General Conditions for inspection, assessment, technical assistance. The issuance of this report does not exonerate buyers or sellers from exercising all their rights and discharging all their liabilities under the contract of sales. Stipulations to the contrary are not binding on the company. The company's responsibility under this report is limited to proven negligence and will in no case be more than eight times the amount of the fees or commission, which will be paid by free Man-day.

17.	Notifications and message function check	<input checked="" type="checkbox"/>	<input type="checkbox"/>	<input type="checkbox"/>	Meet basic usage	5pcs
18.	Contacts function check	<input checked="" type="checkbox"/>	<input type="checkbox"/>	<input type="checkbox"/>	Meet basic usage.	5pcs
19.	Pedometer function check	<input checked="" type="checkbox"/>	<input type="checkbox"/>	<input type="checkbox"/>	Meet basic usage.	5pcs
20.	Alarm function check	<input checked="" type="checkbox"/>	<input type="checkbox"/>	<input type="checkbox"/>	Meet basic usage.	5pcs
21.	Music control function check	<input checked="" type="checkbox"/>	<input type="checkbox"/>	<input type="checkbox"/>	Meet basic usage.	5pcs
22.	Remote camera function test	<input checked="" type="checkbox"/>	<input type="checkbox"/>	<input type="checkbox"/>	Meet basic usage.	5pcs
23.	Find my phone function test	<input checked="" type="checkbox"/>	<input type="checkbox"/>	<input type="checkbox"/>	Meet basic usage.	5pcs
24.	Screen scratch resistance test	<input checked="" type="checkbox"/>	<input type="checkbox"/>	<input type="checkbox"/>	Meet basic usage.	5pcs
25.	Timer function test	<input checked="" type="checkbox"/>	<input type="checkbox"/>	<input type="checkbox"/>	Meet basic usage.	5pcs
26.	Stopwatch function test	<input checked="" type="checkbox"/>	<input type="checkbox"/>	<input type="checkbox"/>	Meet basic usage.	5pcs
27.	Calculator function test	<input checked="" type="checkbox"/>	<input type="checkbox"/>	<input type="checkbox"/>	Meet basic usage.	5pcs
28.	Theme function check	<input checked="" type="checkbox"/>	<input type="checkbox"/>	<input type="checkbox"/>	Meet basic usage.	5pcs
29.	Weather and temperature function check	<input checked="" type="checkbox"/>	<input type="checkbox"/>	<input type="checkbox"/>	Meet basic usage.	5pcs
30.	Siri function test	<input checked="" type="checkbox"/>	<input type="checkbox"/>	<input type="checkbox"/>	Meet basic usage.	5pcs
31.	Sedentary reminder function check	<input checked="" type="checkbox"/>	<input type="checkbox"/>	<input type="checkbox"/>	Meet basic usage.	5pcs
32.	Reset function check	<input checked="" type="checkbox"/>	<input type="checkbox"/>	<input type="checkbox"/>	Meet basic usage.	5pcs
33.	Charging test	<input checked="" type="checkbox"/>	<input type="checkbox"/>	<input type="checkbox"/>	Meet basic usage.	5pcs
34.	Water proof test	<input type="checkbox"/>	<input type="checkbox"/>	<input checked="" type="checkbox"/>	Factory refused to do this test	N/A
35.	Pull test	<input checked="" type="checkbox"/>	<input type="checkbox"/>	<input type="checkbox"/>	Meet basic usage.	5pcs
36.	Fitting test	<input checked="" type="checkbox"/>	<input type="checkbox"/>	<input type="checkbox"/>	Meet basic usage.	5pcs
37.	Voice memo function check	<input checked="" type="checkbox"/>	<input type="checkbox"/>	<input type="checkbox"/>	Meet basic usage.	5pcs
38.	Menu check	<input checked="" type="checkbox"/>	<input type="checkbox"/>	<input type="checkbox"/>	Meet basic usage.	8pcs
39.	Screen quality check	<input type="checkbox"/>	<input checked="" type="checkbox"/>	<input type="checkbox"/>	1pc with scratched marking 1pc with The bottom of the screen turns blue 6pcs with skew screen	125pcs
40.	Abuse test	<input checked="" type="checkbox"/>	<input type="checkbox"/>	<input type="checkbox"/>	Meet basic usage.	8pcs
41.	Accessible sharp Point & Sharp edges check (if any,)	<input checked="" type="checkbox"/>	<input type="checkbox"/>	<input type="checkbox"/>	No accessible sharp points or edges found, meet basic usage.	125pcs
42.	Structure & Workmanship	<input checked="" type="checkbox"/>	<input type="checkbox"/>	<input type="checkbox"/>	The judge for reference only, subject to problematic remark on 1 st page.	3pcs
43.	Odor check	<input checked="" type="checkbox"/>	<input type="checkbox"/>	<input type="checkbox"/>	No particular smell found, acceptable.	125pcs
44.	Cleanliness check	<input checked="" type="checkbox"/>	<input type="checkbox"/>	<input type="checkbox"/>	Acceptable, except defects on AQLs.	125pcs

ON-SITE TESTS (Photos)

1. Below photos to demonstrate the technique & process for certain on-site testing item.
2. For different products with the same testing item, only one photo will be taken as evidence.
3. It reflects the actual test result under the on-site testing condition provided, the testing result
4. can't be a documentary evidence for any disputes, for your reference only.



Barcode Scanning test



Barcode Scanning test



Download the application



Download the application



Download the application



Download the application

Notice: This report is issued by the company under its General Conditions for inspection, assessment, technical assistance. The issuance of this report does not exonerate buyers or sellers from exercising all their rights and discharging all their liabilities under the contract of sales. Stipulations to the contrary are not binding on the company. The company's responsibility under this report is limited to proven negligence and will in no case be more than eight times the amount of the fees or commission, which will be paid by free Man-day.

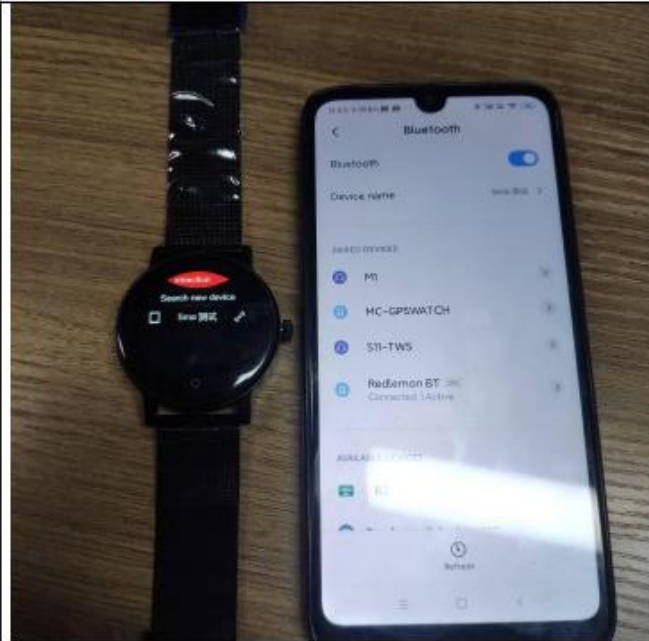

Bluetooth connection test



Bluetooth connection test



Bluetooth connection test at a distance of 10 meters



Bluetooth connection test at a distance of 10 meters



Heart rate function check



Step function check



Weather function check



System language setting



Music control function check



Music control function check



Sedentary reminder function check



Calendar function check



Remote camera



Calculator function test



Stopwatch function test

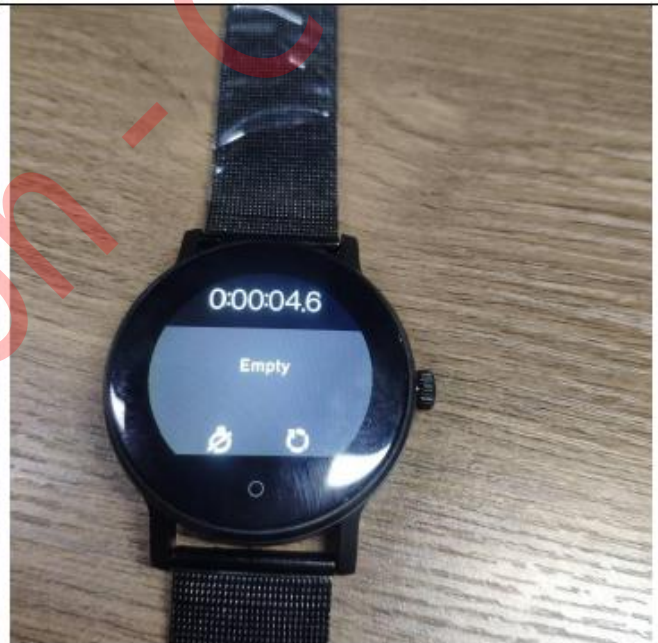

Timer function test



Contacts function check

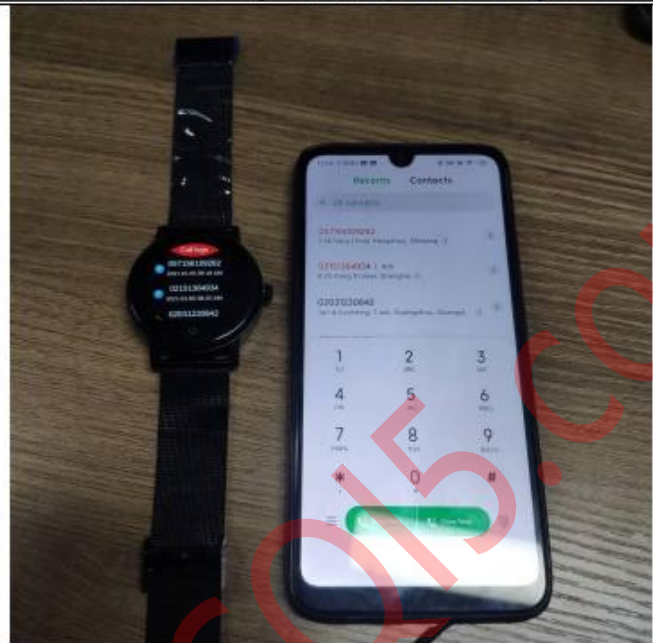

Call logs

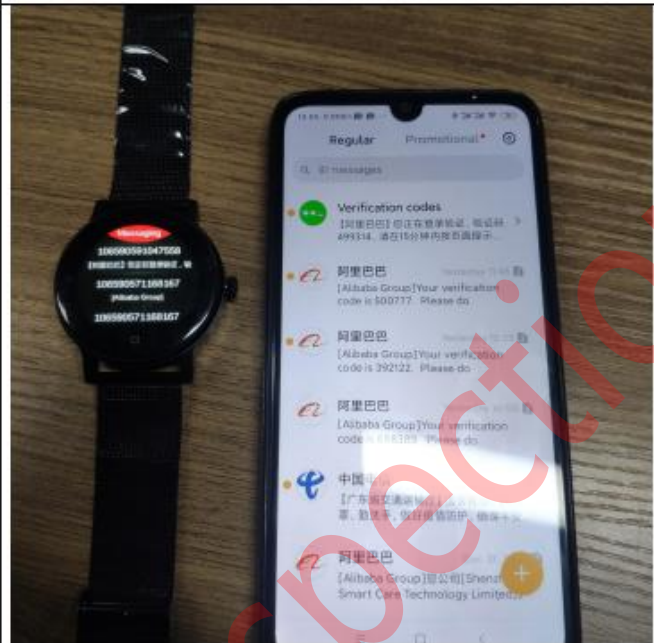

synchronize the messages of the phone

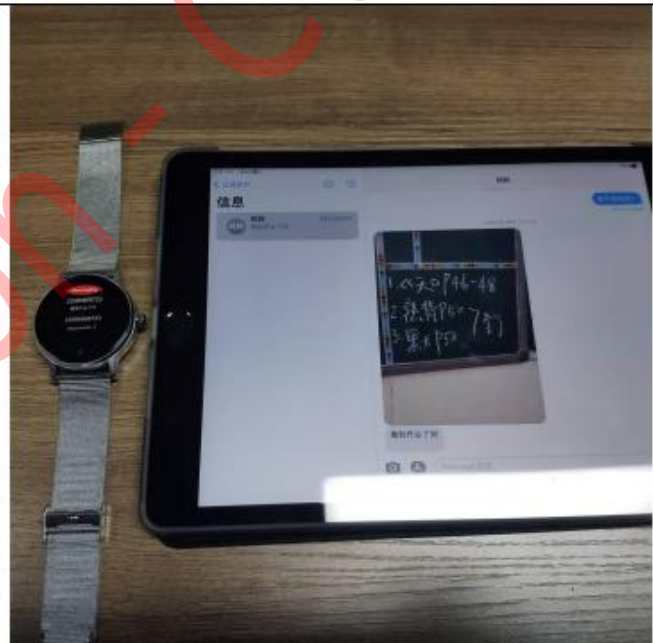

synchronize the messages of the phone



synchronize the notifications



synchronize the notifications



synchronize the notifications



Contacts function check



Blue name check



Blue name check

Notice: This report is issued by the company under its General Conditions for inspection, assessment, technical assistance. The issuance of this report does not exonerate buyers or sellers from exercising all their rights and discharging all their liabilities under the contract of sales. Stipulations to the contrary are not binding on the company. The company's responsibility under this report is limited to proven negligence and will in no case be more than eight times the amount of the fees or commission, which will be paid by free Man-day.

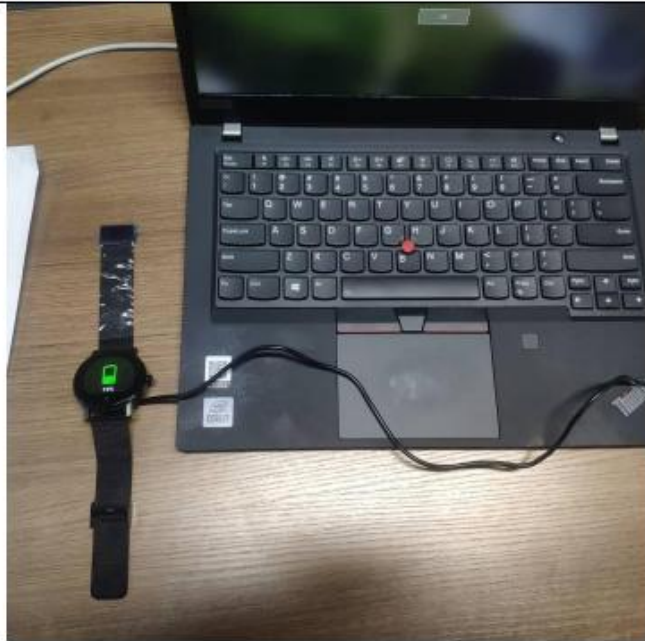

Charging test

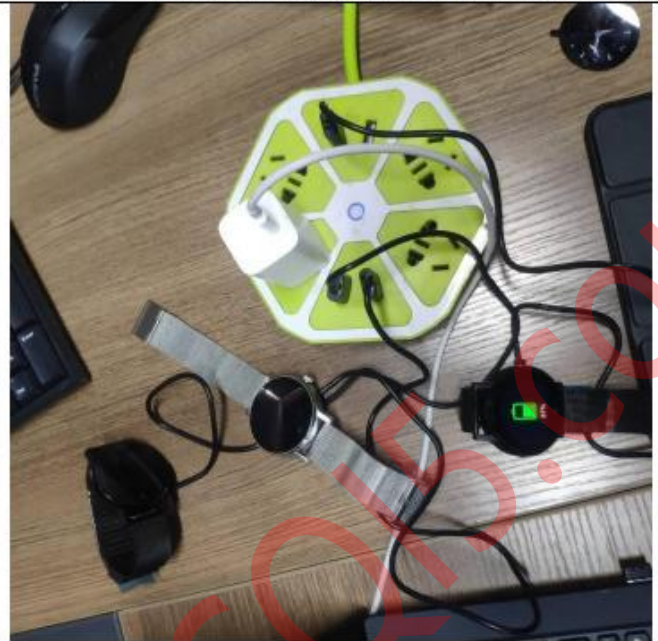

Charging test



Internal check



Internal check



Internal check



Internal check



Standby current



Working current



3M adhesive test



3M adhesive test



3M adhesive test



3M adhesive test



Screen scratch resistance test



Screen scratch resistance test



Fitting test



Fitting test



Pull test



Find my phone

Product size and weight









ON-SITE MEASUREMENT FOR TECHNICAL DATA

Item No:	Parameter required on PO	Parameter required on unit packaging	Overall size of products
77161	255mm*47.5mm*14.4mm	N/A	245mm x 47.6mm x 14.4mm
Cable	606mm	N/A	610mm

Item No:	Product net weight for single piece	Product net weight (with unit packing)	Gross weight of outer carton (PO required)	Gross weight (printed on outer carton)	Actual G.W. (+/-5%)
77161	79g	208g	13.4kgs	13.4kgs	13.0

Item No:	Carton size(LxWxH) (PO required)	Carton size(LxWxH) (Printed on Carton)	Actual Carton size(LxWxH) (+/-5%)
77161	N/A	49x32x30	49x32.7x30.6

Supplier	Inspector	Supervisor		Your Decision for the Inspection		
Jenny	Roger	<input checked="" type="checkbox"/> Dick F	<input type="checkbox"/> Mark W	<input type="checkbox"/> Agree with result <input checked="" type="checkbox"/> Conditional <input type="checkbox"/> Accept <input type="checkbox"/> Other	Customer Sign.	Sign. Date
		<input type="checkbox"/> Jeff L	<input type="checkbox"/> Allen G		N/A	N/A
Our inspectors have notified supplier/factory not to effect shipment until get final approval from you.				Your Comments.:	N/A	

Factory's Co-operation	<input type="checkbox"/> Good	<input checked="" type="checkbox"/> Average	<input type="checkbox"/> Poor	<input type="checkbox"/> Very bad
Weather Conditions	<input type="checkbox"/> Sunny	<input checked="" type="checkbox"/> Cloudy	<input type="checkbox"/> Rainy	<input type="checkbox"/> N/A
Inspection Site	<input checked="" type="checkbox"/> QC Room	<input type="checkbox"/> Warehouse	<input type="checkbox"/> Workshop	<input type="checkbox"/> Harbor

PHOTO DOCUMENT

Photos for Products' Marking & Labeling & Packing
Packaging



Outer carton view



Outer carton view



Outer carton view



Outer carton view



weight



dimension



dimension



dimension



60pcs per carton



Color box view



Color box view



Color box view



Color box view



Color box view



Color box view



Color box size



Color box size



Color box size



Color box weight

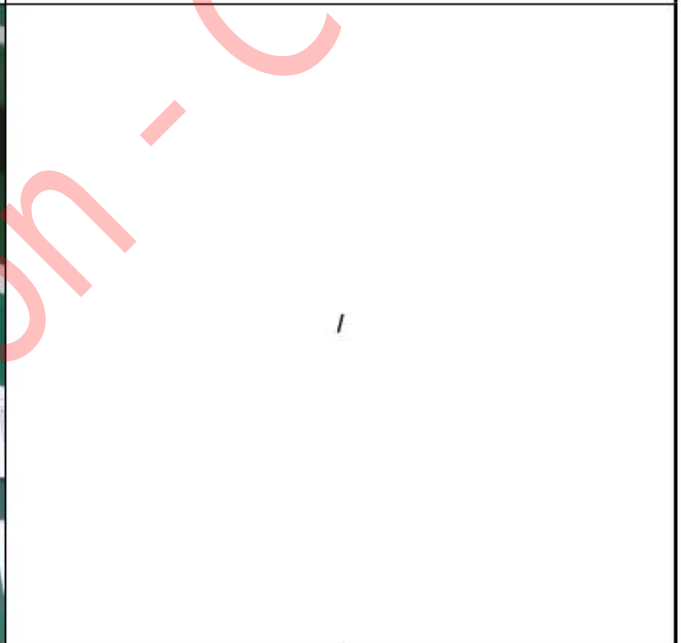

Inner box

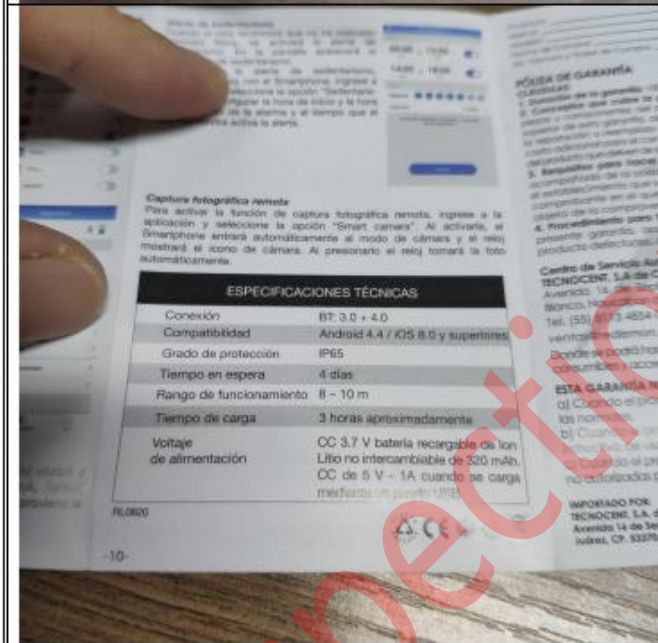

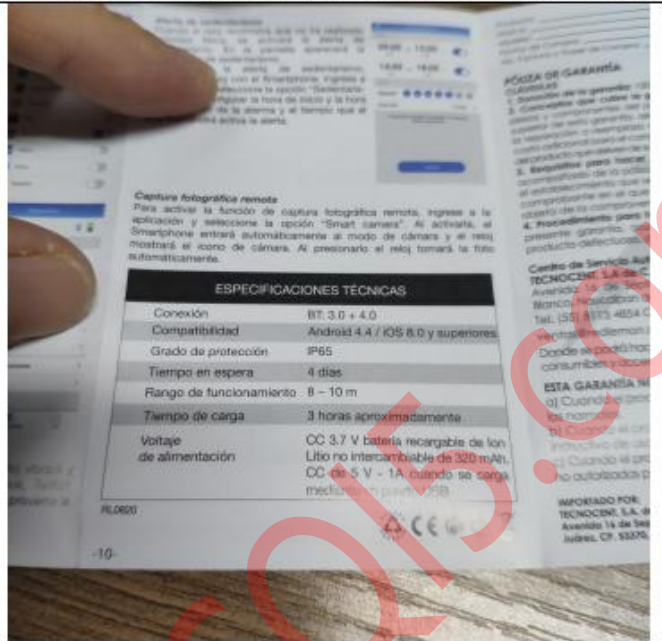
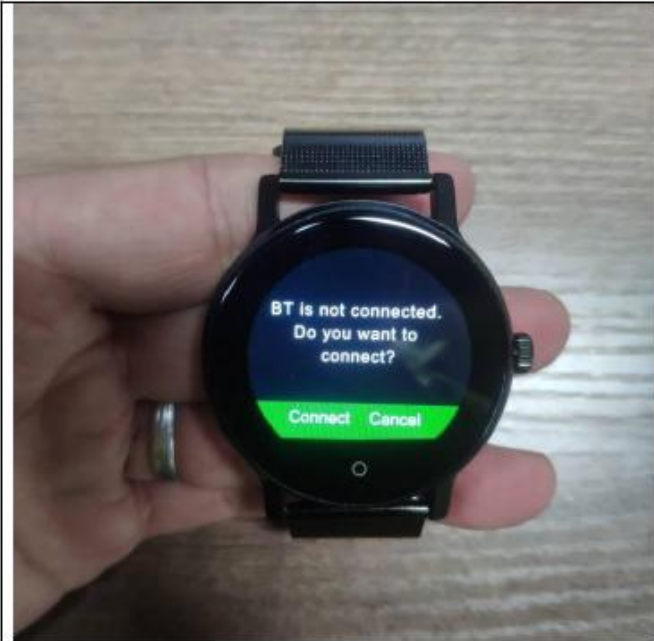

Accessory



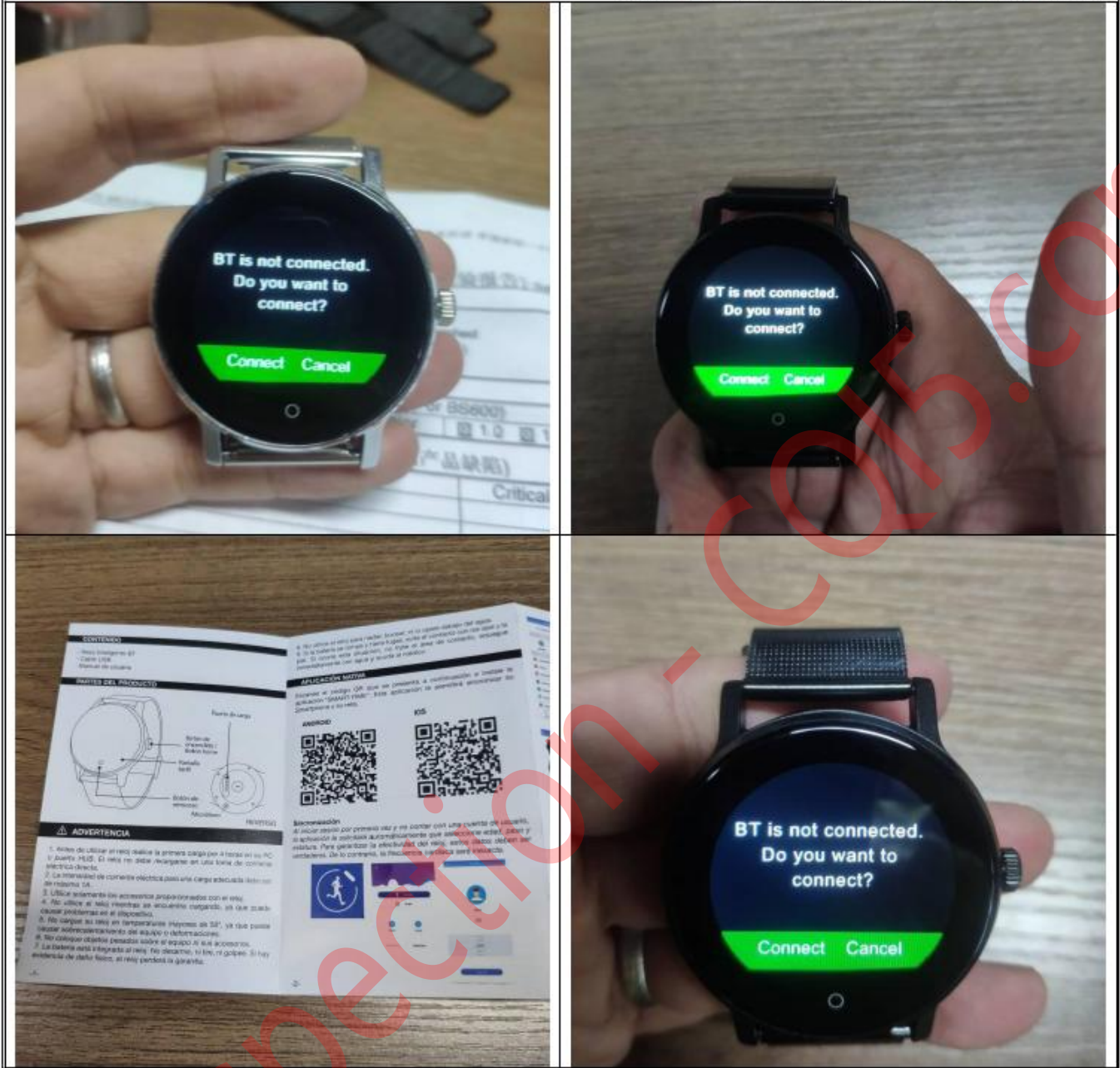

Notice: This report is issued by the company under its General Conditions for inspection, assessment, technical assistance. The issuance of this report does not exonerate buyers or sellers from exercising all their rights and discharging all their liabilities under the contract of sales. Stipulations to the contrary are not binding on the company. The company's responsibility under this report is limited to proven negligence and will in no case be more than eight times the amount of the fees or commission, which will be paid by free Man-day.



Notice: This report is issued by the company under its General Conditions for inspection, assessment, technical assistance. The issuance of this report does not exonerate buyers or sellers from exercising all their rights and discharging all their liabilities under the contract of sales. Stipulations to the contrary are not binding on the company. The company's responsibility under this report is limited to proven negligence and will in no case be more than eight times the amount of the fees or commission, which will be paid by free Man-day.



Warehouse



Cargos stacking



Factory building view(3F)



Factory



Factory workshop

End of the report